

Backset Conversion Menu for D400-DF67 Deadbolt Latch

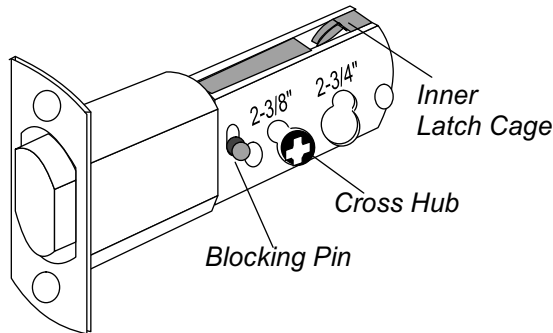

The D400-DF67 UL-Deadbolt is 2-3/8" and 2-3/4" field - convertible. The Deadbolt packed is set for 2-3/8" backset. You may apply the Faceplate furnished onto the Latch Front for installation if 2-3/8" backset is your application.

To convert the latch to 2-3/4", simply hold both ends of the **Blocking Pin** with 2 fingers, to lift up and hold in position; and then use the other hand - one finger to hold the **Hub-Arm-Tail** (top) and one finger to hold the **Hub-Spring** (bottom), pull/extend the **Inner Latch Cage** until the **Cross Hub** is located inside the round window of 2-3/4". Release the **Blocking Pin**. It's done

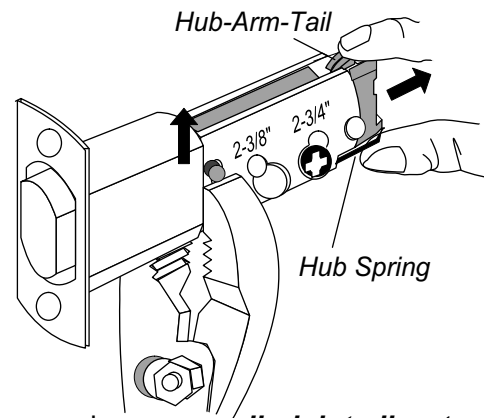

You may also use a **slip-joint pliers** to push up the **Blocking-Pin** and hold in position instead of using the fingers. If a pliers is in use, make sure just give enough pressure to hold the **Blocking-Pin** in up position. Over tightening could damage the latch construction. To set the **slip-joint pliers** for wider clamping position reduces the clamping pressure.

To convert the backset back to 2-3/8", simply lift up the **Blocking-Pin** and snap back the **Inner Latch Cage** until the **Cross-Hub** is located/clicked inside the 2-3/8" window.